

How to link your **newmobilitynews** app to your subscription?

Four steps to get you going

1. Go to **My Account** on the <http://www.newmobility.news> website



2. Log in (if you aren't already)

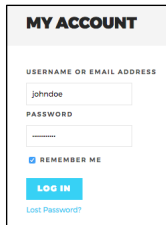

The screenshot shows a login form titled 'MY ACCOUNT'. It has two input fields: 'USERNAME OR EMAIL ADDRESS' with 'johndoe' entered, and 'PASSWORD' which is empty. Below the fields is a 'REMEMBER ME' checkbox and a blue 'LOG IN' button. A link for 'Lost Password?' is at the bottom.

3. Choose **ADD NEW MOBILE DEVICE**. A token will be generated automatically, to be used **within five minutes** on your mobile device

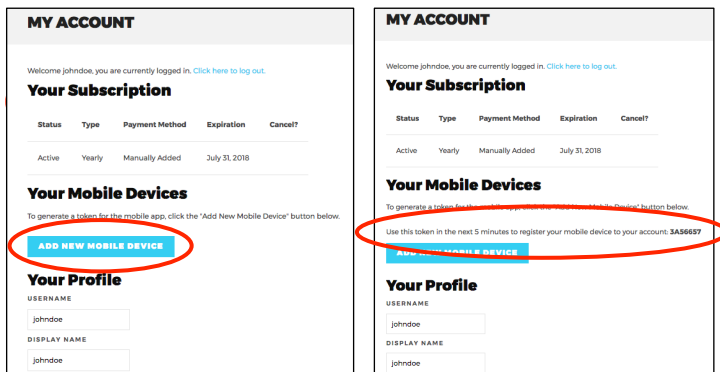

4. On your mobile device, open the app and choose menu to go to login

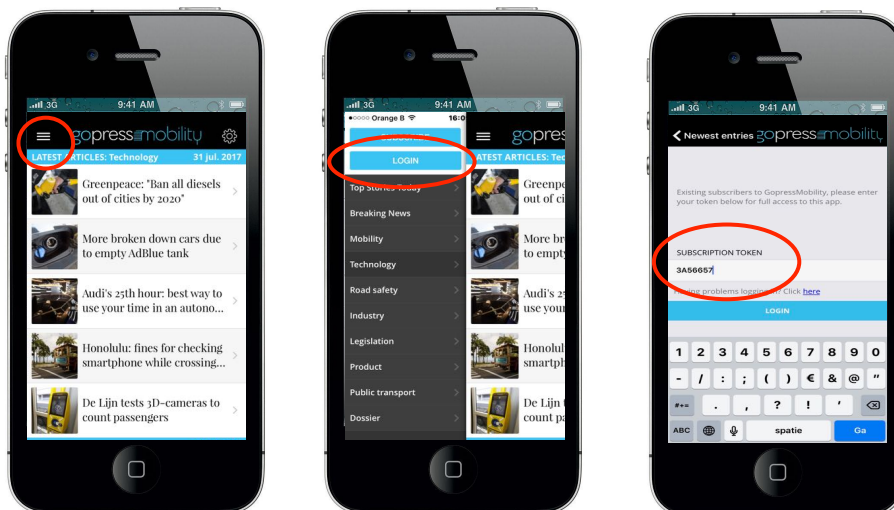

Type or copy paste the token under SUBSCRIPTION TOKEN

Choose LOGIN

You're all set: same options will apply (unlimited access) as for the website.

You can link up to 3 mobile devices to your subscription by repeating the procedure.